

| | |
|-------------|-------------------|
| DWG. NO.: | REVISION DATE: |
| A-0 | 08-26-2018 |
| BLDG. CODE: | SCALE: |
| DH | NTS |
| | DESIGN BY: |
| | PLL |
| | CHECKED BY: |
| | JCD |

**RECORD FLOOR PLAN
DEVILBISS HALL**

BASEMENT FLOOR PLAN

SALISBURY UNIVERSITY
 FACILITIES PLANNING & CAPITAL PROJECTS
 ARCHITECTURAL AND ENGINEERING SERVICES
 1101 CAMDEN AVENUE
 SALISBURY, MARYLAND 21801
 410 - 543 - 6215

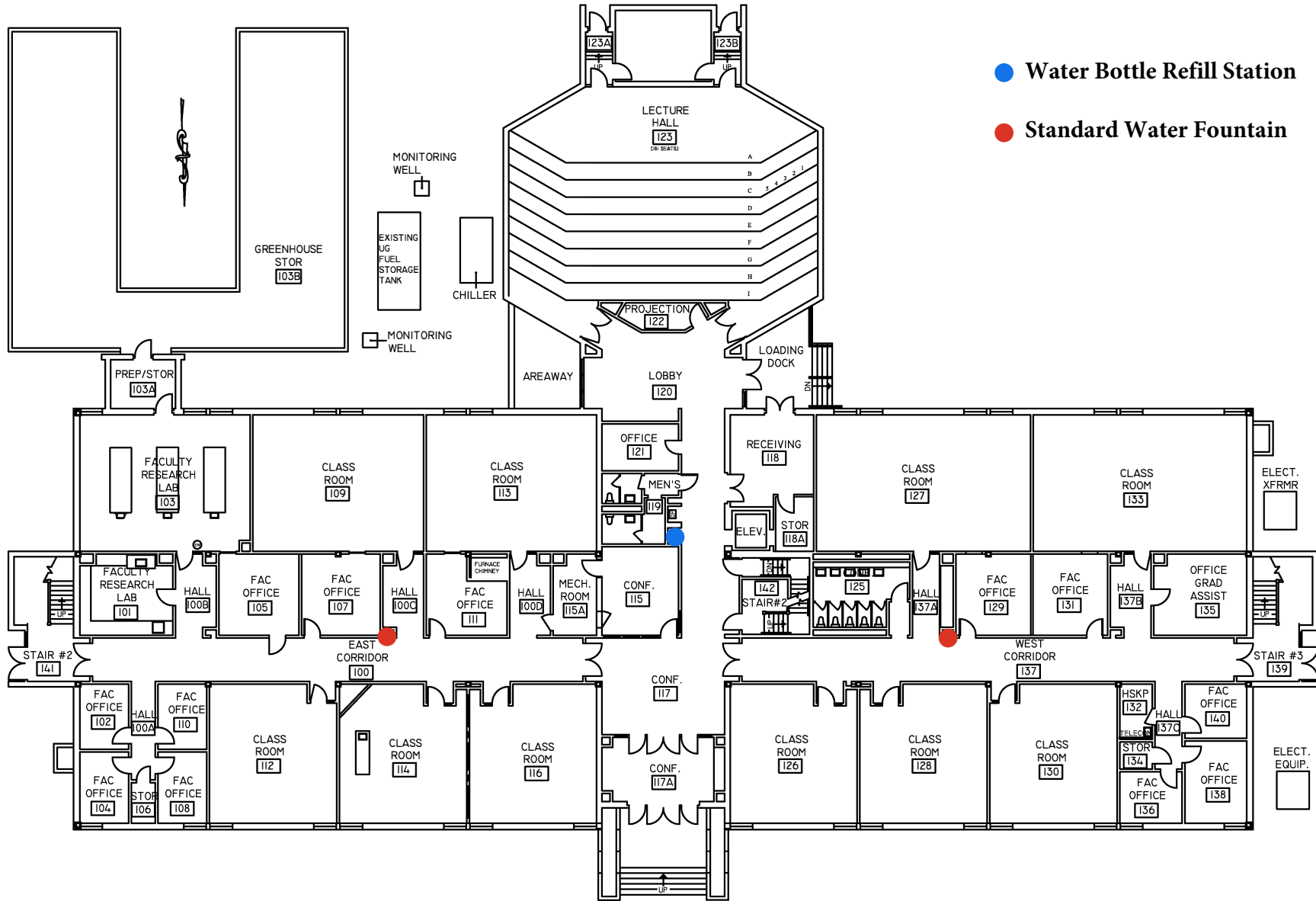

● Water Bottle Refill Station

● Standard Water Fountain

| | |
|-------------|-------------------|
| DWG. NO.: | REVISION DATE: |
| A-1 | 08-26-2018 |
| SCALE: | NTS |
| DESIGN BY: | PLL |
| BLDG. CODE: | DH |
| CHECKED BY: | JCD |

**RECORD FLOOR PLAN
DEVILBISS HALL**

FIRST FLOOR PLAN

SALISBURY UNIVERSITY
 FACILITIES PLANNING & CAPITAL PROJECTS
 ARCHITECTURAL AND ENGINEERING SERVICES
 1101 CAMDEN AVENUE
 SALISBURY, MARYLAND 21801
 410 - 543 - 6215

● Water Bottle Refill Station

● Standard Water Fountain

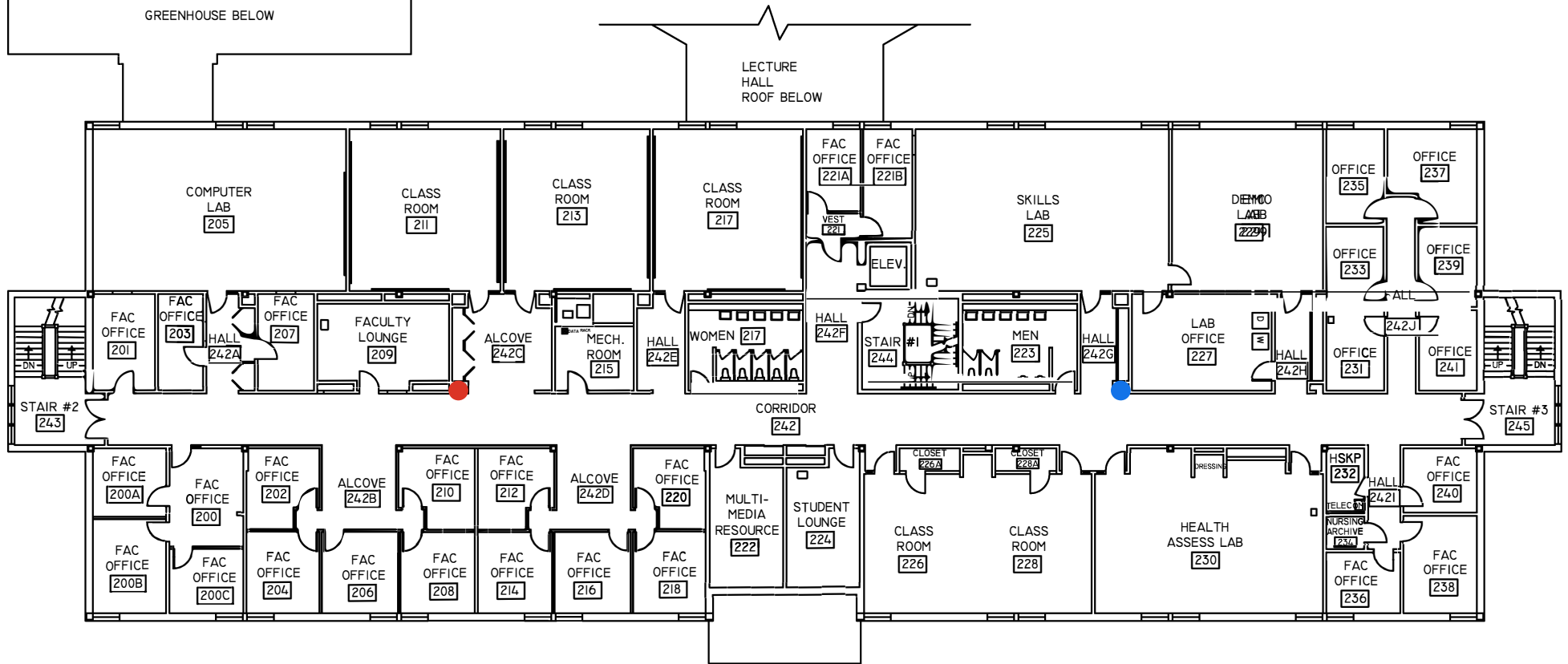

| | |
|-------------|-------------------|
| DWG. NO.: | REVISION DATE: |
| A-2 | 08-25-2018 |
| BLDG. CODE: | SCALE: |
| DH | NTS |
| | DESIGN BY: |
| | PLL |
| | CHECKED BY: |
| | JCD |

**RECORD FLOOR PLAN
DEVILBISS HALL**

SECOND FLOOR PLAN

SALISBURY UNIVERSITY
FACILITIES PLANNING & CAPITAL PROJECTS
ARCHITECTURAL AND ENGINEERING SERVICES
1101 CAMDEN AVENUE
SALISBURY, MARYLAND 21801
410 - 543 - 6215

● Water Bottle Refill Station

● Standard Water Fountain

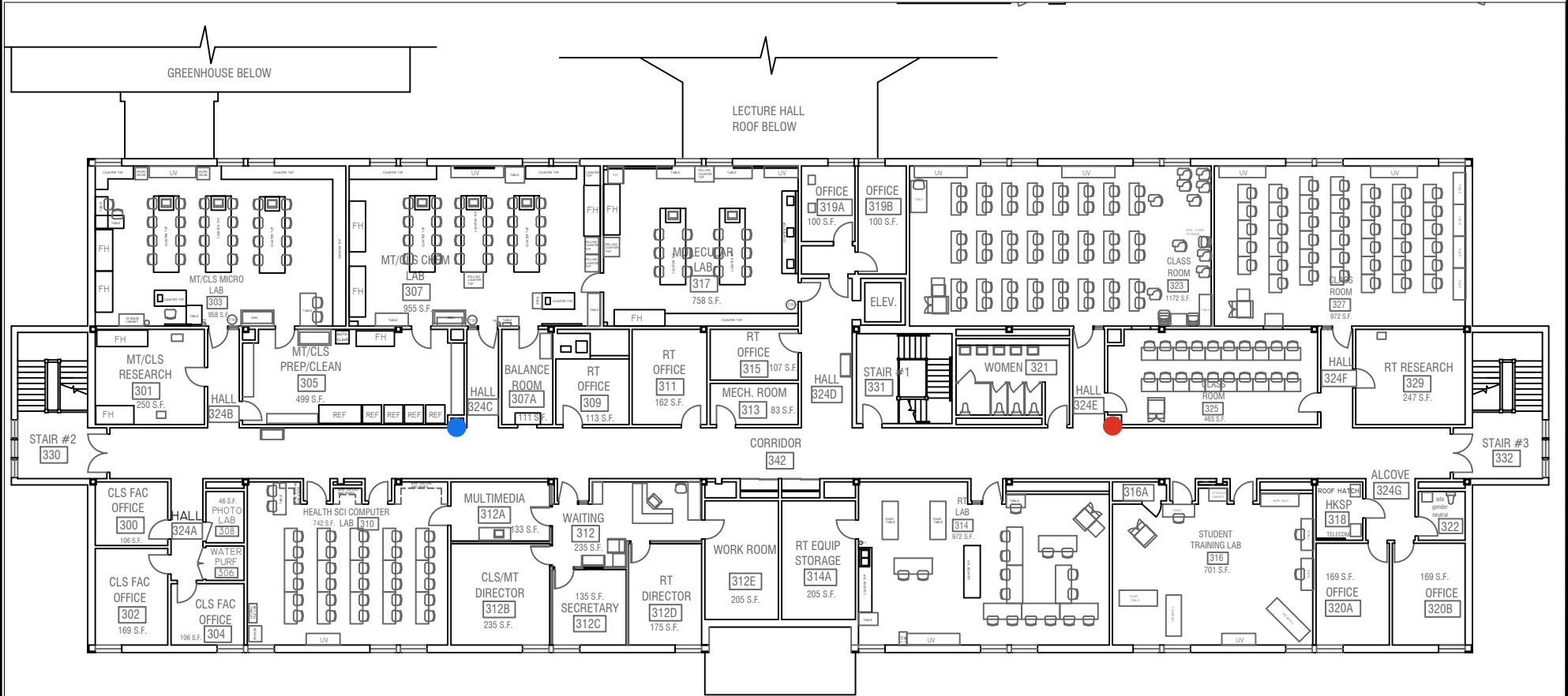

DWG. NO.:

A-3

ISSUE DATE:
JUNE 25, 2021

SCALE:
NTS

DESIGN BY:
PLL

CHECKED BY:
JCD

PROJECT
NAME:

RECORD FLOOR PLAN
DEVILBISS HALL
THIRD FLOOR PLAN

SALISBURY UNIVERSITY

FACILITIES PLANNING & CAPITAL PROJECTS
ARCHITECTURAL AND ENGINEERING SERVICES

1101 CAMDEN AVENUE
SALISBURY, MARYLAND 21801

410 - 543 - 6215